

# STAINLESS STEEL 316L PRESS FIT FITTINGS (M PROFILE)

COMPLY WITH BSEN1254-2: 1998

## MALE JOINT CONNECTOR



A Product of the nPressGuard® Solution

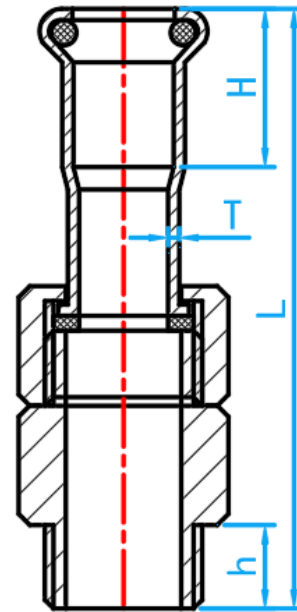

CROSS SECTIONAL VIEW

### STANDARD SPECIFICATION

Working Pressure	16 Bar
Working Temperature	0 ~ 85°C
Applications	Hot and cold potable water system.

### DIMENSIONS

SKU	SIZE (mm x inch)	L (mm)	H (mm)	h (mm)	T (mm)	WEIGHT (kg)	PCS/CTN
SS316LPFNMJC01515	15 × 1/2" BSPT	88	20	15	1.5	0.110	180
SS316LPFNMJC02020	22 × 3/4" BSPT	87	21	17	1.5	0.157	150
SS316LPFNMJC02525	28 × 1" BSPT	96	23	19	1.5	0.225	70
SS316LPFNMJC03525	35 × 1" BSPT	96	26	19	1.5	0.230	60
SS316LPFNMJC03535	35 × 1 1/4" BSPT	100	26	21	1.5	0.302	60
SS316LPFNMJC04225	42 × 1" BSPT	115	31	19	1.5	0.275	34
SS316LPFNMJC04242	42 × 1 1/2" BSPT	107	31	22	1.5	0.430	34
SS316LPFNMJC05025	54 × 1" BSPT	125	36	19	1.5	0.315	24
SS316LPFNMJC05050	54 × 2" BSPT	130	36	27	1.5	0.620	24
SS316LPFNMJC06565	67 × 2 1/2" BSPT	165	50	30	1.8	0.670	10
SS316LPFNMJC08080*	76 × 3" BSPT	180	51	33	2.0	1.440	5
SS316LPFNMJC100100*	108 × 4" BSPT	250	75	38	2.0	2.760	6

\*This item requires special ordering. Please consult with a salesperson for the estimated lead time.